

BLP Rulmanlı Fırdöndü Kaldırma Mapası

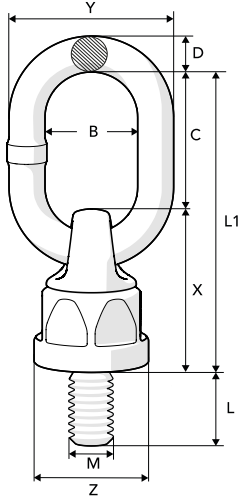

Art.No.	Model	Ölçüler (mm)										Ağırlık (kg)
		B	C	D	L	L1	M	X	Y	Z		
2903 39 08	BLP-M8 x 1.25	35	55	13	16	112	8	57	61	Ø42	0.6	
2903 39 10	BLP -M10 x 1.5	35	55	13	20	112	10	57	61	Ø42	0.6	
2903 39 12	BLP -M12 x 1.75	35	55	13	24	112	12	57	61	Ø42	0.6	
2903 39 16	BLP-M16 x 2	35	55	13	30	112	16	57	61	Ø42	0.6	
2903 39 20	BLP-M20 x 2.5	34	57	17	30	148	20	75	67	Ø59	1.3	
2903 39 24	BLP-M24 x 3	45	80	17	36	171	24	75	80	Ø59	1.5	
2903 39 30	BLP-M30 x 3.5	50	96	22	45	199	30	103	95	Ø74	3.4	
2903 39 36	BLP-M36 x 4	50	96	22	54	199	36	103	95	Ø74	3.5	
2903 39 42	BLP-M42 x 4.5	70	120	28	63	242	42	122	127	Ø93	6.5	
2903 39 48	BLP-M48 x 5	70	120	28	72	242	48	122	127	Ø93	6.8	

- Dar alan ✓
- Dikey kaldırma ✓
- Açılı kaldırma ✓
- Yük altında eğim ✓
- Yük altında dikey dönme hareketi ✓
- Tek noktadan kaldırma ✓
- Çok noktadan kaldırma ✓
- Hassas yük yüzeyi ✓

BLP Çalışma Yük Limitleri

Simetrik yük (t)	Sapan Bacak Sayısı										Tork anahtarı	Allen anahtarı
	1	1	2	2	2	2 simetrik	3-4 simetrik					
Açı β	0°	90°	0°	0-45°	90°	0 - 45°	45 - 60°	0 - 45°	45 - 60°			
BLP -M8 x 1.25	0.6	0.3	1.2	0.4	0.6	0.4	0.3	0.6	0.45	10 Nm	36 mm	
BLP -5/16"-18 UNC	0.6	0.3	1.2	0.4	0.6	0.4	0.3	0.6	0.45	7 Ft.Lbs	1 1/2"	
BLP -M10 x 1.5	1.2	0.6	2.4	0.8	1.2	0.8	0.6	1.3	0.90	15 Nm	36 mm	
BLP -3/8"-16 UNC	1.0	0.5	2.0	0.7	1.0	0.7	0.5	1.1	0.75	11 Ft.Lbs	1 1/2"	
BLP -M12 x 1.75	1.5	0.75	3.0	1.1	1.5	1.1	0.75	1.5	1.1	27 Nm	36 mm	
BLP -1/2"-13 UNC	1.5	0.75	3.0	1.1	1.5	1.0	0.75	1.5	1.1	20 Ft.Lbs	1 1/2"	
BLP -M16 x 2	3.0	1.5	6.0	2.1	3.0	2.1	1.5	3.1	2.2	60 Nm	36 mm	
BLP -5/8"-11 UNC	3.0	1.5	6.0	2.1	3.0	2.1	1.5	3.1	2.2	44 Ft.Lbs	1 1/2"	
BLP -M20 x 2.5	5.0	2.5	10.0	3.5	5.0	3.5	2.5	5.2	3.7	90 Nm	50mm	
BLP -3/4"-10 UNC	4.5	2.25	9.0	3.1	4.5	3.1	2.25	4.7	3.3	66 Ft.Lbs	2"	
BLP -7/8"-9 UNC	6.0	3.0	12.0	4.2	6.0	4.2	3.0	6.3	4.5	66 Ft.Lbs	2"	
BLP -M24 x 3	7.0	4.0	14.0	5.6	8.0	5.6	4.0	8.4	6.0	135 Nm	50mm	
BLP -1"-8 UNC	7.0	4.0	14.0	5.6	8.0	5.6	4.0	8.4	6.0	100 Ft.Lbs	2"	
BLP -M30 x 3.5	12.0	6.0	24.0	8.4	12.0	8.4	6.0	12.6	9.0	270 Nm	65 mm	
BLP -1 1/4" -7 UNC	12.0	6.0	24.0	8.4	12.0	8.4	6.0	12.6	9.0	200 Ft.Lbs	2 5/8"	
BLP -M36 x 4	14.0	8.0	28.0	11.2	16.0	11.2	8.0	16.8	12.0	320 Nm	65 mm	
BLP -1 1/2" -6 UNC	14.0	8.0	28.0	11.2	16.0	11.2	8.0	16.8	12.0	236 Ft.Lbs	2 5/8"	
BLP -M42 x 4.5	16.0	10.0	32.0	14.0	20.0	14.0	10.0	21.0	15.0	600 Nm	85 mm	
BLP -1 3/4" -5 UNC	16.0	10.0	32.0	14.0	20.0	14.0	10.0	21.0	15.0	440 Ft.Lbs	3 1/8"	
BLP -M48 x 5	18.0	13.0	36.0	18.2	26.0	18.2	13.0	27.3	19.5	800 Nm	85 mm	
BLP -2"-4.5 UNC	18.0	13.0	36.0	18.2	26.0	18.2	13.0	27.3	19.5	590 Ft.Lbs	3 1/8"	